



THE
JAMAICA GAZETTE
SUPPLEMENT

PROCLAMATIONS, RULES AND REGULATIONS

12G

Vol. CXLII

WEDNESDAY, JANUARY 16, 2019

No. 3B

No. 3B

**THE REGISTRATION OF TITLES, CADASTRAL MAPPING AND TENURE
CLARIFICATION (SPECIAL PROVISIONS) ACT**

THE REGISTRATION OF TITLES, CADASTRAL MAPPING AND TENURE
CLARIFICATION (SPECIAL PROVISIONS) (SECTION 5—PART OF CHARLES LYNCH KNOWN
AS CHOCOLATE HOLE IN THE PARISH OF SAINT ELIZABETH) ORDER, No. 0165/2018

In exercise of the power conferred upon the Minister by section 5 of the Registration of
Titles, Cadastral Mapping and Tenure Clarification (Special Provisions) Act, 2005, the following
Order is hereby made:—

1. This Order shall be cited as the Registration of Titles, Cadastral Mapping and Tenure
Clarification (Special Provisions) (Section 5—Part of Charles Lynch known as Chocolate
Hole in the parish of Saint Elizabeth) Order, No. 0165/2018.

2. The landowner has informally subdivided the land as outlined below and has occupied
it in its present state. An application was submitted to the Office of Titles at the National
Land Agency to have the applicant become the registered proprietor of the land. Subdivision
approval from the Saint Elizabeth Municipal Corporation or an Order under section 5(a)(i)

of the Registration of Titles, Cadastral Mapping and Tenure Clarification (Special Provisions) Act, 2005 is to be furnished in support of the application. In light of the above the Honourable Minister is being asked to make an Order waiving the requirement for subdivision approval pursuant to section 5 of the said Cadastral Mapping and Tenure Clarification (Special Provisions) Act, 2005.

3. The *Local Improvements Act*, the *Natural Resources Conservation Authority Act* and the *Town and Country Planning Act* shall not apply in relation to any transfer or registration of any portion of the land described in Part I of the First Schedule.

4. Any transfer or registration of any portion of the land described in Part I of the First Schedule must be in conformity with the Plan described in Part II of the First Schedule and must be subject to the conditions outlined in the Second Schedule.

FIRST SCHEDULE

(Paragraph 2)

PART I

All that parcel of land part of Charles Lynch known as Chocolate Hole, in the parish of Saint Elizabeth, butting and bounding as appears by survey diagram bearing Plan Examination Number in the table below as follows:

<u>Applicant Name</u>	<u>Plan Examination Number</u>	<u>Parcel Size (M²)</u>	<u>Place Name</u>	<u>Parish</u>
Aldyth Brooks	332456	7,493.41	Charles Lynch known as Chocolate Hole	Saint Elizabeth

FIRST SCHEDULE, *contd.*

PART II

Plan of land part of Charles Lynch known as Chocolate Hole, in the parish of Saint Elizabeth as set out in table at Part I above.

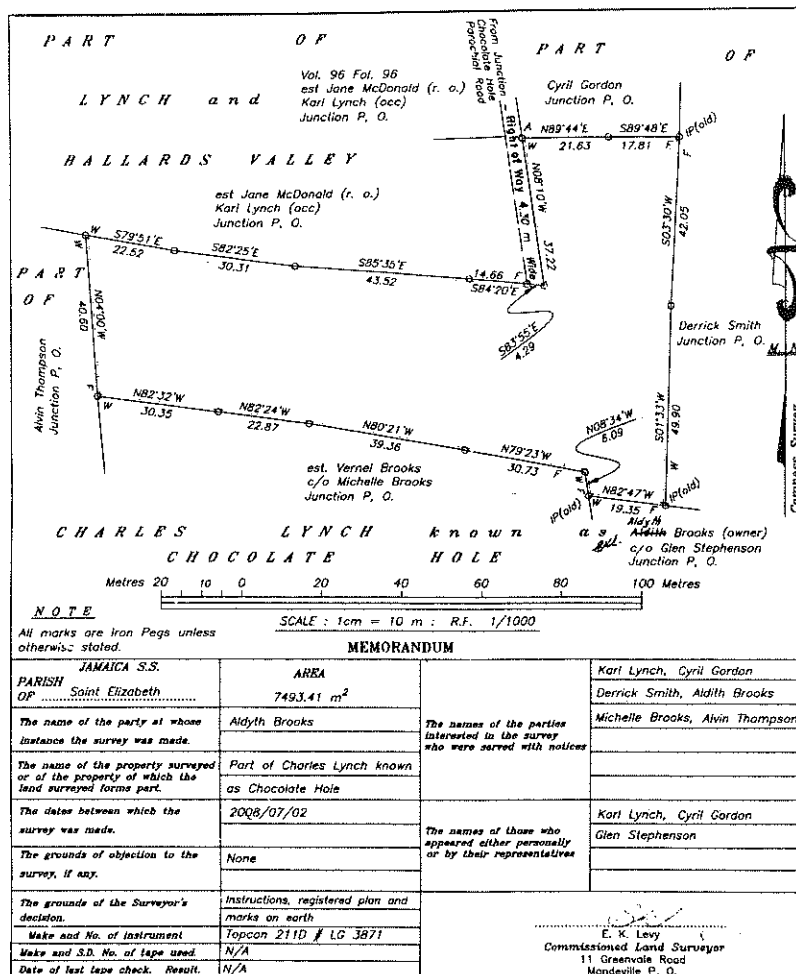
FIRST SCHEDULE, *contd.*PART II, *contd.*

SECOND SCHEDULE

(Paragraph 3)

Covenants

1. There being no breach of existing covenants.

Dated this 15th day of January, 2019.

ANDREW HOLNESS, ON, MP,
Prime Minister and Minister of Economic
Growth and Job Creation.