



THE
JAMAICA GAZETTE
SUPPLEMENT

PROCLAMATIONS, RULES AND REGULATIONS

536U⁷¹

Vol. CXLII

FRIDAY, AUGUST 30, 2019

No. 93K

No. 1520

**THE REGISTRATION OF TITLES, CADASTRAL MAPPING AND TENURE
CLARIFICATION (SPECIAL PROVISIONS) ACT**

THE REGISTRATION OF TITLES, CADASTRAL MAPPING AND TENURE
CLARIFICATION (SPECIAL PROVISIONS) (SECTION 5—PART OF GAYLE
IN THE PARISH OF SAINT MARY) ORDER, No. 0196/2019

In exercise of the power conferred upon the Minister by section 5 of the Registration of Titles, Cadastral Mapping and Tenure Clarification (Special Provisions) Act, 2005, the following Order is hereby made:—

1. This Order shall be cited as the Registration of Titles, Cadastral Mapping and Tenure Clarification (Special Provisions) (Section 5—Part of Gayle in the parish of Saint Mary) Order, No. 0196/2019.

2. The landowner has informally subdivided the land as outlined below and has occupied it in its present state. An application has been made to the Office of Titles at the National Land Agency to have the applicant become the registered proprietor of the portion of land to be transferred. Subdivision approval from the Saint Mary Municipal Corporation or an

Order under section 5(a)(i) of the Registration of Titles, Cadastral Mapping and Tenure Clarification (Special Provisions) Act, 2005 is to be furnished in support of the application. In light of the above the Honourable Minister is being asked to make an Order waiving the requirement for subdivision approval pursuant to section 5 of the said Cadastral Mapping and Tenure Clarification (Special Provisions) Act, 2005.

3. The *Local Improvements Act*, the *Natural Resources Conservation Authority Act* and the *Town and Country Planning Act* shall not apply in relation to any transfer or registration of any portion of the land described in Part I of the First Schedule.

4. Any transfer or registration of any portion of the land described in Part I of the First Schedule must be in conformity with the Plan described in Part II of the First Schedule and must be subject to the conditions outlined in the Second Schedule.

FIRST SCHEDULE

(Paragraph 2)

PART I

All that parcel of land part of Gayle, in the parish of Saint Mary, butting and bounding as appears by survey diagram bearing Plan Examination Number in the table below as follows:

Applicant Name	Plan Examination Number	Parcel Size (M ²)	Place Name	Parish
Joy Verona Allen	342424	3561.39	Gayle	Saint Mary

FIRST SCHEDULE, *contd.*

PART II

Plan of land part of Gayle, in the parish of Saint Mary as set out in table at Part I above.

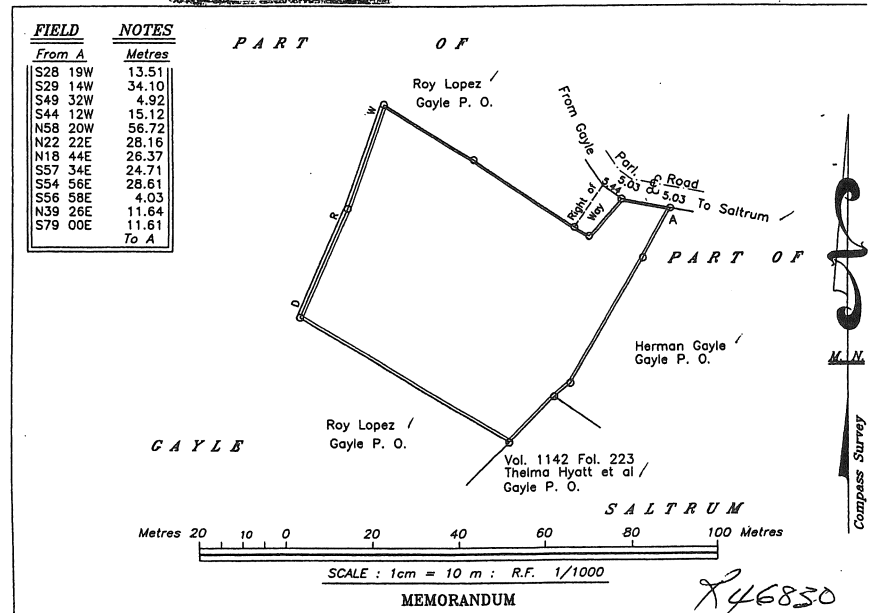
FIRST SCHEDULE, *contd.*PART II, *contd.***REMARKS**

All marks are Iron Pegs unless otherwise stated
This plan supersedes plan bearing S.D. Ex. No. 270022

JAMAICA S.S.	AREA		Roy Lopez, Herman Gayle
PARISH Saint Mary	3561.39 m ² /		Thelma Hyatt
The name of the party at whose instance the survey was made.	Joy Allen & Glenda Dennis	The names of the parties interested in the survey who were served with notices	The Secretary Saint Mary Parish Council
The name of the property surveyed or of the property of which the land surveyed forms part.	Part of Gayle		
The dates between which the survey was made.	2008/06/24		Patricia Bramwell for Thelma Hyatt
The grounds of objection to the survey, if any.	None	The names of those who appeared either personally or by their representatives	Roy Lopez
The grounds of the Surveyor's decision.	Instructions, registered plan and marks on earth		
Make and No. of instrument	Nikon DTM 521 # 035825		
Make and S.D. No. of tape used.	N/A		

[Signature]
Fitz M. Henry
Commissioned Land Surveyor
D. N. No. 720

SECOND SCHEDULE

(Paragraph 3)

Covenants

1. There being no breach of existing covenants.

Dated this 12th day of August, 2019.

ANDREW HOLNESS, ON, MP,
Prime Minister and Minister of Economic
Growth and Job Creation.