



THE
JAMAICA GAZETTE
SUPPLEMENT

PROCLAMATIONS, RULES AND REGULATIONS

560A

Vol. CXLIV

TUESDAY, APRIL 20, 2021

No. 35A

No. 44A

**THE REGISTRATION OF TITLES, CADASTRAL MAPPING AND TENURE
CLARIFICATION (SPECIAL PROVISIONS) ACT**

THE REGISTRATION OF TITLES, CADASTRAL MAPPING AND TENURE
CLARIFICATION (SPECIAL PROVISIONS) (SECTION 5—PART OF BELLEVUE
IN THE PARISH OF ST. CATHERINE) ORDER, NO. 0061/2021

In exercise of the power conferred upon the Minister by section 5 of the Registration of Titles, Cadastral Mapping and Tenure Clarification (Special Provisions) Act, 2005, the following Order is hereby made:—

1. This Order shall be cited as the Registration of Titles, Cadastral Mapping and Tenure Clarification (Special Provisions) (Section 5—Part of Bellevue in the parish of St. Catherine) Order, No. 0061/2021.

2. The landowner has informally subdivided the land as outlined below and has occupied it in its present state. An application is to be made to the Office of Titles at the National Land Agency to have the applicant become the registered proprietor of the portions of land to be transferred. Subdivision approval from the St. Catherine Municipal Corporation

or an Order under section 5(a)(i) of the Registration of Titles, Cadastral Mapping and Tenure Clarification (Special Provisions) Act, 2005 is to be furnished in support of the application. In light of the above the Honourable Minister is being asked to make an Order waiving the requirement for subdivision approval pursuant to section 5 of the said Cadastral Mapping and Tenure Clarification (Special Provisions) Act, 2005.

3. The *Local Improvements Act*, the *Natural Resources Conservation Authority Act* and the *Town and Country Planning Act* shall not apply in relation to any transfer or registration of any portion of the land described in Part I of the First Schedule.

4. Any transfer or registration of any portion of the land described in Part I of the First Schedule must be in conformity with the Plan described in Part II of the First Schedule and must be subject to the conditions outlined in the Second Schedule.

FIRST SCHEDULE

(Paragraph 2)

PART I

All that parcel of land part of Bellevue in the parish of St. Catherine, butting and bounding as appears by survey diagram bearing Plan Examination Number in the table below as follows:

<u>Applicant Name</u>	<u>Plan Examination Number</u>	<u>Parcel Size (M²)</u>	<u>Place Name</u>	<u>Parish</u>
Monica Currie	257624	473.57	Bellevue	St. Catherine

FIRST SCHEDULE, *contd.*

PART II

Plan of land part of Bellevue in the parish of St. Catherine as set out in table at Part I above.

FIRST SCHEDULE, *contd.*

PART II, *contd.*

COMPASSING OFFICE
 200403 R.32845

BOUNDARY											
STATION	BEARING	DIST. (m.)		STATION	BEARING	DIST. (m.)		STATION	BEARING	DIST. (m.)	
20 - 19	S 41	18 W	10.97								
19 - 18	S 09	35 W	17.88								
18 - 28	N 57	35 W	19.05								
23 - 24	N 51	39 E	20.56								
25 - 20	S 70	25 E	16.55								
AREA		473.57 Sq. metres									
TIE											
20 - 21	S 83	47 E	41.51								

P A R T O F

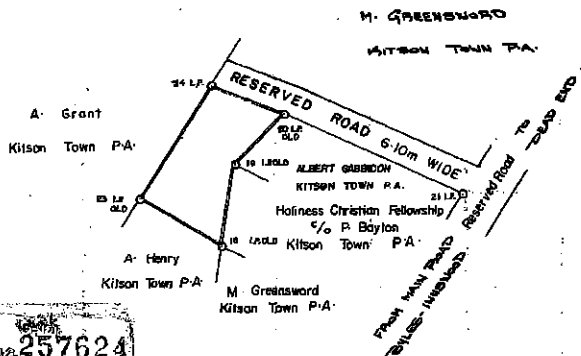

257624
 R. HADDAD
 COMMISSIONED LAND SURVEYOR
 35 GARDENIA AVE., MONA, KGN. 6
 TEL: 927-0596

B E L L E U V E

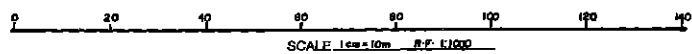

PARISH OF: St. Catherine's
 PROPERTY SURVEYED: Part of Bellevue
 SURVEYED FOR: Monica Williams
 SURVEYED ON: 14th March 1997
 REMARKS: There were no objections to the Survey made from Marks, Instructions and Plan.
 MAKE and NO. of INSTRUMENT: WILD TO 293378
 MAKE and NO. of TAPE: K&E P.1051
 DATE and RESULT of LAST TAPE CHECK: 23rd APRIL 1996 Satisfactory
 COMPASS BEARING 305° 28' READING ON 21st APRIL 1986

NOTICES WERE SERVED ON: A: Rowland M. Greensword
 P: Bayton for Holiness Christian Fellowship A: Henry
 Albert Gabbidon
 THOSE WHO APPEARED: NO ONE

RICHARD A. HADDAD
 COMMISSIONED LAND SURVEYOR
 35 GARDENIA AVE., MONA, KGN. 6
 TEL: 927-0596

Drawn by S.R. REID

SECOND SCHEDULE

(Paragraph 3)

Covenants

1. There being no breach of existing covenants.

Dated this 22nd day of March, 2021.

ANDREW HOLNESS, ON, MP,
Prime Minister and Minister of Economic
Growth and Job Creation.