



THE  
**JAMAICA GAZETTE**  
**SUPPLEMENT**

**PROCLAMATIONS, RULES AND REGULATIONS**

3688G

Vol. CXLIII

THURSDAY, NOVEMBER 19, 2020

No. 156D

No. 182D

**THE REGISTRATION OF TITLES, CADASTRAL MAPPING AND TENURE  
CLARIFICATION (SPECIAL PROVISIONS) ACT**

THE REGISTRATION OF TITLES, CADASTRAL MAPPING AND TENURE  
CLARIFICATION (SPECIAL PROVISIONS) (SECTION 5—PART OF ROSEBERRY IN THE PARISH  
OF SAINT ELIZABETH) ORDER, NO. 0417/2020

In exercise of the power conferred upon the Minister by section 5 of the Registration of Titles, Cadastral Mapping and Tenure Clarification (Special Provisions) Act, 2005, the following Order is hereby made:—

1. This Order shall be cited as the Registration of Titles, Cadastral Mapping and Tenure Clarification (Special Provisions) (Section 5—Part of Roseberry in the parish of Saint Elizabeth) Order, No. 0417/2020.

2. The landowner has informally subdivided the land as outlined below and has occupied it in its present state. An application is to be made to the Office of Titles at the National Land Agency to have the applicant become the registered proprietor of the portions of land to be transferred. Subdivision approval from the Saint Elizabeth Municipal Corporation

or an Order under section 5(a)(i) of the Registration of Titles, Cadastral Mapping and Tenure Clarification (Special Provisions) Act, 2005 is to be furnished in support of the application. In light of the above the Honourable Minister is being asked to make an Order waiving the requirement for subdivision approval pursuant to section 5 of the said Cadastral Mapping and Tenure Clarification (Special Provisions) Act, 2005.

3. The *Local Improvements Act*, the *Natural Resources Conservation Authority Act* and the *Town and Country Planning Act* shall not apply in relation to any transfer or registration of any portion of the land described in Part I of the First Schedule.

4. Any transfer or registration of any portion of the land described in Part I of the First Schedule must be in conformity with the Plan described in Part II of the First Schedule and must be subject to the conditions outlined in the Second Schedule.

## FIRST SCHEDULE

(Paragraph 2)

## PART I

All that parcel of land part of Roseberry in the parish of Saint Elizabeth, butting and bounding as appears by survey diagram bearing Plan Examination Number in the table below as follows:

Applicant Name	Plan Examination Number	Parcel Size (M <sup>2</sup> )	Place Name	Parish
James Folkes	390770	1,928.241	Roseberry	Saint Elizabeth

---

---

FIRST SCHEDULE, *contd.*

PART II

Plan of land part of Roseberry in the parish of Saint Elizabeth as set out in table at Part I above.

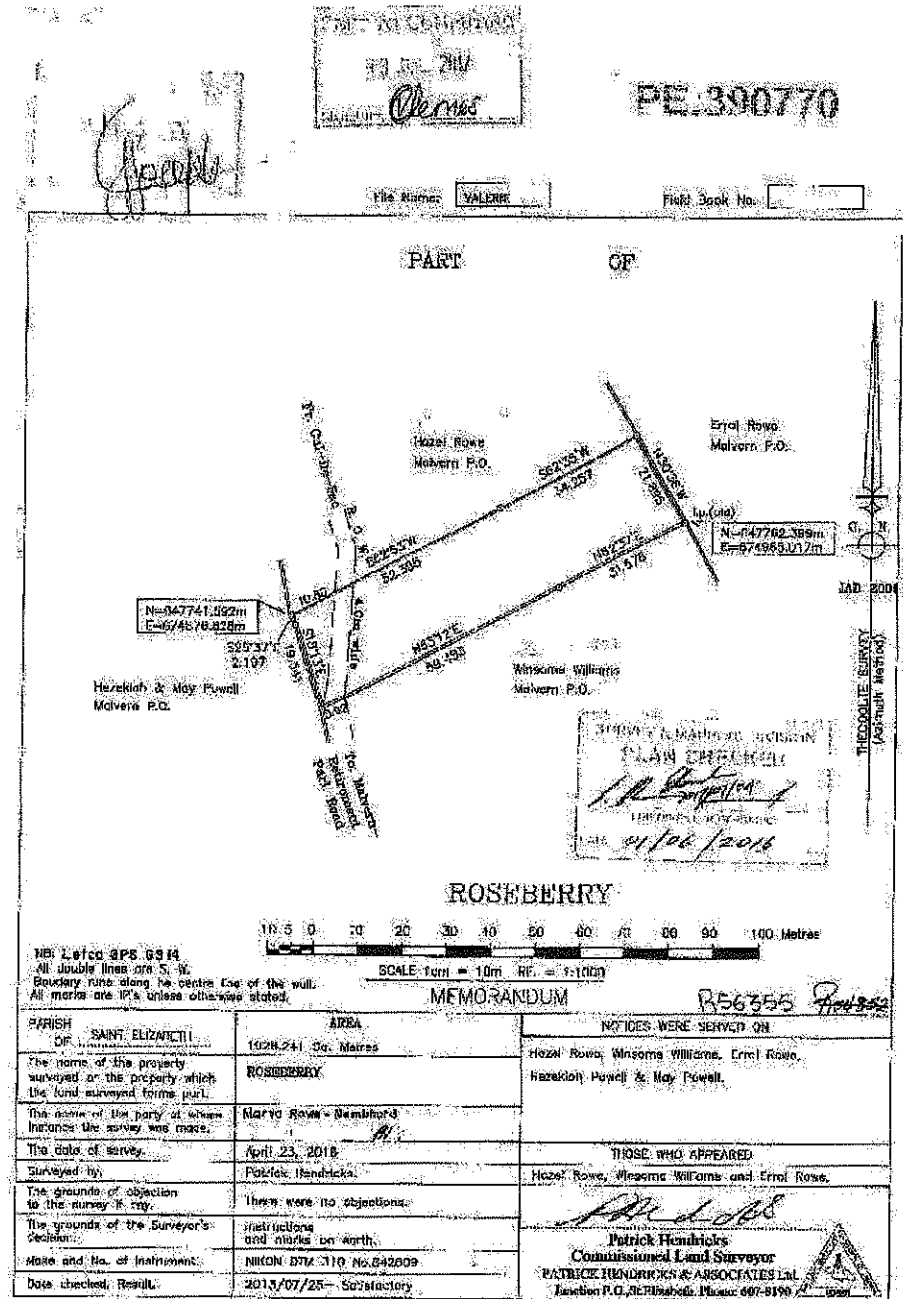
FIRST SCHEDULE, *contd.*PART II, *contd.*

## SECOND SCHEDULE

(Paragraph 3)

*Covenants*

1. There being no breach of existing covenants.

Dated this 21st day of September, 2020.

ANDREW HOLNESS, ON, MP,  
Prime Minister and Minister of Economic  
Growth and Job Creation.