



THE
JAMAICA GAZETTE
SUPPLEMENT

PROCLAMATIONS, RULES AND REGULATIONS

447

Vol. CXLIV

THURSDAY, APRIL 8, 2021

No. 28

No. 29

**THE REGISTRATION OF TITLES, CADASTRAL MAPPING AND TENURE
CLARIFICATION (SPECIAL PROVISIONS) ACT**

THE REGISTRATION OF TITLES, CADASTRAL MAPPING AND TENURE
CLARIFICATION (SPECIAL PROVISIONS) (SECTION 5—PART OF WALLENS
IN THE PARISH OF ST. CATHERINE) ORDER, No. 0490/2020

In exercise of the power conferred upon the Minister by section 5 of the Registration of Titles, Cadastral Mapping and Tenure Clarification (Special Provisions) Act, 2005, the following Order is hereby made:—

1. This Order shall be cited as the Registration of Titles, Cadastral Mapping and Tenure Clarification (Special Provisions) (Section 5—Part of Wallens in the parish of St. Catherine) Order, No. 0490/2020.
2. The landowner has informally subdivided the land as outlined below and has occupied it in its present state. An application has been made to the Office of Titles at the National Land Agency to have the applicant become the registered proprietor of the portion of land to be transferred. Subdivision approval from the St. Catherine Municipal Corporation or an

Order under section 5(a)(i) of the Registration of Titles, Cadastral Mapping and Tenure Clarification (Special Provisions) Act, 2005 is to be furnished in support of the application. In light of the above the Honourable Minister is being asked to make an Order waiving the requirement for subdivision approval pursuant to section 5 of the said Cadastral Mapping and Tenure Clarification (Special Provisions) Act, 2005.

3. The *Local Improvements Act*, the *Natural Resources Conservation Authority Act* and the *Town and Country Planning Act* shall not apply in relation to any transfer or registration of any portion of the land described in Part I of the First Schedule.

4. Any transfer or registration of any portion of the land described in Part I of the First Schedule must be in conformity with the Plan described in Part II of the First Schedule and must be subject to the conditions outlined in the Second Schedule.

FIRST SCHEDULE

(Paragraph 2)

PART I

All that parcel of land part of Wallens, in the parish of St. Catherine, butting and bounding as appears by survey diagram bearing Plan Examination Number in the table below as follows:

<u>Applicant Name</u>	<u>Plan Examination Number</u>	<u>Parcel Size (M²)</u>	<u>Place Name</u>	<u>Parish</u>
Imogene Thompson	365766	812.529	Wallens	St. Catherine

FIRST SCHEDULE, *contd.*

PART II

Plan of land part of Wallens, in the parish of St. Catherine as set out in table at Part I above.

FIRST SCHEDULE, *contd.*

PART II, *contd.*

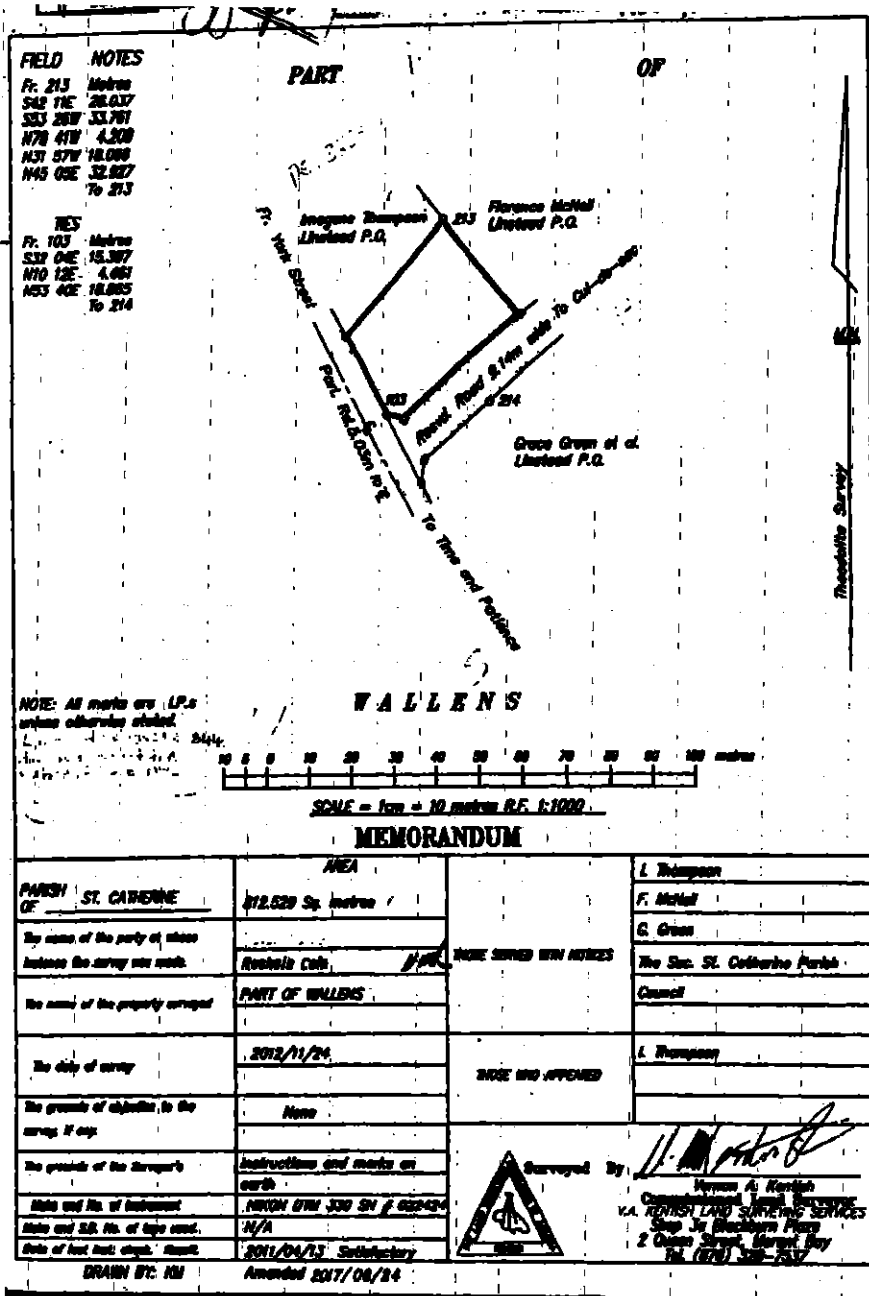

FIELD NOTES
 Fr. 213 Metres
 S42 11E 28.637
 S53 26W 33.791
 N78 41' 4.30
 N31 57W 18.088
 N45 08E 32.827
 To 213

RES
 Fr. 103 Metres
 S52 04E 15.587
 N10 12E 4.681
 N53 40E 18.085
 To 214

NOTE: All marks are L.P.s unless otherwise stated.
 244



SCALE = 1cm = 10 metres R.F. 1:1000

MEMORANDUM

PARISH OF	ST. CATHERINE	AREA	112.529 Sq. metres		L. Thompson
The name of the party of whom business the survey was made	Rochelle Cook	BEING SURVEYED WITH METRES			F. Metel
The name of the property surveyed	PART OF WALLENS				G. Green
The date of survey	2012/11/24	DATE AND APPROVED			The Sec. St. Catherine Parish Council
The grounds of appeal, in the survey, if any	None				L. Thompson
The grounds of the Surveyor's	Instructions and marks on map				
Date and No. of instrument	NATION 07M 330 S1 P 022424				
Date and S.B. No. of tape used	N/A				
Date of last best check	2011/04/13 Satisfactory				



Surveyed By: *[Signature]*
 Vernon A. Kerlich
 Commonwealth Land Surveyor
 V.A. KERLICH LAND SURVEYING SERVICES
 Shop Jc. Beckwith Plaza
 2 Queen Street, Mount Joy
 Tel. (773) 348-1517

SECOND SCHEDULE

(Paragraph 3)

Covenants

1. There being no breach of existing covenants.

Dated this 11th day of January, 2021.

ANDREW HOLNESS, ON, MP,
Prime Minister and Minister of Economic
Growth and Job Creation.