

THE
JAMAICA GAZETTE
SUPPLEMENT

PROCLAMATIONS, RULES AND REGULATIONS

3648x¹

Vol CXLIII

MONDAY, NOVEMBER 2, 2020

No. 149D¹

No. 175D¹

**THE REGISTRATION OF TITLES, CADASTRAL MAPPING AND TENURE
CLARIFICATION (SPECIAL PROVISIONS) ACT**

THE REGISTRATION OF TITLES, CADASTRAL MAPPING AND TENURE
CLARIFICATION (SPECIAL PROVISIONS) (SECTION 5—PART OF BLenheim
IN THE PARISH OF MANCHESTER) ORDER, No. 0399/2020

In exercise of the power conferred upon the Minister by section 5 of the Registration of Titles, Cadastral Mapping and Tenure Clarification (Special Provisions) Act, 2005, the following Order is hereby made:—

1. This Order shall be cited as the Registration of Titles, Cadastral Mapping and Tenure Clarification (Special Provisions) (Section 5—Part of Blenheim in the parish of Manchester) Order, No. 0399/2020.

2. The landowner has informally subdivided the land as outlined below and has occupied it in its present state. An application is to be made to the Office of Titles at the National Land Agency to have the applicant become the registered proprietor of the portion of land to be transferred. Subdivision approval from the Manchester Municipal Corporation or an

Order under section 5(a)(i) of the Registration of Titles, Cadastral Mapping and Tenure Clarification (Special Provisions) Act, 2005 is to be furnished in support of the application. In light of the above the Honourable Minister is being asked to make an Order waiving the requirement for subdivision approval pursuant to section 5 of the said Cadastral Mapping and Tenure Clarification (Special Provisions) Act, 2005.

3. The *Local Improvements Act*, the *Natural Resources Conservation Authority Act* and the *Town and Country Planning Act* shall not apply in relation to any transfer or registration of any portion of the land described in Part I of the First Schedule.

4. Any transfer or registration of any portion of the land described in Part I of the First Schedule must be in conformity with the Plan described in Part II of the First Schedule and must be subject to the conditions outlined in the Second Schedule.

FIRST SCHEDULE

(Paragraph 2)

PART I

All that parcel of land part of Blenheim, in the parish of Manchester, butting and bounding as appears by survey diagram bearing Plan Examination Number in the table below as follows:

Applicants Name	Plan Examination Number	Parcel Size (M ²)	Place Name	Parish	Lot	Vol/Folio
JAMALCO for General Alumina Jamaica Limited	382541	0.319	Blenheim	Manchester	1	1536/800
JAMALCO for General Alumina Jamaica Limited	382541	0.498	Blenheim	Manchester	157	1536/800
JAMALCO for General Alumina Jamaica Limited	382541	0.500	Blenheim	Manchester	158	1536/800
JAMALCO for General Alumina Jamaica Limited	382541	0.504	Blenheim	Manchester	159	1536/800
JAMALCO for General Alumina Jamaica Limited	382541	0.502	Blenheim	Manchester	160	1536/800
JAMALCO for General Alumina Jamaica Limited	382541	1.004	Blenheim	Manchester	161	1536/800

FIRST SCHEDULE, *contd.*PART I, *contd.*

Plan of land part of Blenheim, in the parish of Manchester as set out in table at Part I above.

Applicants Name	Plan Examination Number	Parcel Size (M ²)	Place Name	Parish	Lot	Vol/Folio
JAMALCO for General Alumina Jamaica Limited	382541	0.081	Blenheim	Manchester	161A	1536/800
JAMALCO for General Alumina Jamaica Limited	382541	0.502	Blenheim	Manchester	162	1536/800
JAMALCO for General Alumina Jamaica Limited	382541	0.502	Blenheim	Manchester	163	1536/800
JAMALCO for General Alumina Jamaica Limited	382541	0.572	Blenheim	Manchester	164	1536/800
JAMALCO for General Alumina Jamaica Limited	382541	0.761	Blenheim	Manchester	184	1536/800
JAMALCO for General Alumina Jamaica Limited	382541	0.603	Blenheim	Manchester	185	1536/800

FIRST SCHEDULE, *contd.*PART I, *contd.*

Plan of land part of Blenheim, in the parish of Manchester as set out in table at Part I above.

Applicants Name	Plan Examination Number	Parcel Size (M ²)	Place Name	Parish	Lot	Vol/Folio
JAMALCO for General Alumina Jamaica Limited	382541	0.502	Blenheim	Manchester	186	1536/800
JAMALCO for General Alumina Jamaica Limited	382541	0.502	Blenheim	Manchester	187	1536/800
JAMALCO for General Alumina Jamaica Limited	382541	2.041	Blenheim	Manchester	213	1536/800
JAMALCO for General Alumina Jamaica Limited	382541	3.009	Blenheim	Manchester	214	1536/800
JAMALCO for General Alumina Jamaica Limited	382541	0.953	Blenheim	Manchester	225	1536/800
JAMALCO for General Alumina Jamaica Limited	382541	0.910	Blenheim	Manchester	226	1536/800

FIRST SCHEDULE, *contd.*PART I, *contd.*

Plan of land part of Blenheim, in the parish of Manchester as set out in table at Part I above.

Applicants Name	Plan Examination Number	Parcel Size (M ²)	Place Name	Parish	Lot	Vol/Folio
JAMALCO for General Alumina Jamaica Limited	382541	0.931	Blenheim	Manchester	227	1536/800
JAMALCO for General Alumina Jamaica Limited	382541	0.916	Blenheim	Manchester	228	1536/800
JAMALCO for General Alumina Jamaica Limited	382541	0.253	Blenheim	Manchester	235	1536/800
JAMALCO for General Alumina Jamaica Limited	382541	0.256	Blenheim	Manchester	236	1536/800
JAMALCO for General Alumina Jamaica Limited	382541	0.253	Blenheim	Manchester	237	1536/800
JAMALCO for General Alumina Jamaica Limited	382541	0.250	Blenheim	Manchester	238	1536/800

FIRST SCHEDULE, *contd.*PART I, *contd.*

Plan of land part of Blenheim, in the parish of Manchester as set out in table at Part I above.

Applicants Name	Plan Examination Number	Parcel Size (M ²)	Place Name	Parish	Lot	Vol/Folio
JAMALCO for General Alumina Jamaica Limited	382541	0.249	Blenheim	Manchester	239	1536/800
JAMALCO for General Alumina Jamaica Limited	382541	0.252	Blenheim	Manchester	240	1536/800
JAMALCO for General Alumina Jamaica Limited	382541	0.253	Blenheim	Manchester	241	1536/800
JAMALCO for General Alumina Jamaica Limited	382541	0.253	Blenheim	Manchester	242	1536/800
JAMALCO for General Alumina Jamaica Limited	382541	0.253	Blenheim	Manchester	243	1536/800
JAMALCO for General Alumina Jamaica Limited	382541	0.252	Blenheim	Manchester	244	1536/800

FIRST SCHEDULE, *contd.*PART I, *contd.*

Plan of land part of Blenheim, in the parish of Manchester as set out in table at

Applicants Name	Plan Examination Number	Parcel Size (M ²)	Place Name	Parish	Lot	Vol/Folio
JAMALCO for General Alumina Jamaica Limited	382541	0.252	Blenheim	Manchester	245	1536/800
JAMALCO for General Alumina Jamaica Limited	382541	0.252	Blenheim	Manchester	246	1536/800
JAMALCO for General Alumina Jamaica Limited	382541	0.252	Blenheim	Manchester	247	1536/800
JAMALCO for General Alumina Jamaica Limited	382541	0.244	Blenheim	Manchester	248	1536/800
JAMALCO for General Alumina Jamaica Limited	382541	0.244	Blenheim	Manchester	249	1536/800
JAMALCO for General Alumina Jamaica Limited	382541	0.252	Blenheim	Manchester	250	1536/800

FIRST SCHEDULE, *contd.*PART I, *contd.*

Plan of land part of Blenheim, in the parish of Manchester as set out in table at

Applicants Name	Plan Examination Number	Parcel Size (M ²)	Place Name	Parish	Lot	Vol/Folio
JAMALCO for General Alumina Jamaica Limited	382541	0.252	Blenheim	Manchester	251	1536/800
JAMALCO for General Alumina Jamaica Limited	382541	0.252	Blenheim	Manchester	252	1536/800
JAMALCO for General Alumina Jamaica Limited	382541	0.252	Blenheim	Manchester	253	1536/800
JAMALCO for General Alumina Jamaica Limited	382541	0.252	Blenheim	Manchester	254	1536/800
JAMALCO for General Alumina Jamaica Limited	382541	0.252	Blenheim	Manchester	255	1536/800
JAMALCO for General Alumina Jamaica Limited	382541	0.252	Blenheim	Manchester	256	1536/800

FIRST SCHEDULE, *contd.*PART I, *contd.*

Plan of land part of Blenheim, in the parish of Manchester as set out in table at Part I above.

Applicants Name	Plan Examination Number	Parcel Size (M ²)	Place Name	Parish	Lot	Vol/Folio
JAMALCO for General Alumina Jamaica Limited	382541	0.250	Blenheim	Manchester	257	1536/800
JAMALCO for General Alumina Jamaica Limited	382541	0.252	Blenheim	Manchester	258	1536/800
JAMALCO for General Alumina Jamaica Limited	382541	0.260	Blenheim	Manchester	259	1536/800
JAMALCO for General Alumina Jamaica Limited	382541	0.260	Blenheim	Manchester	260	1536/800
JAMALCO for General Alumina Jamaica Limited	382541	0.260	Blenheim	Manchester	261	1536/800
JAMALCO for General Alumina Jamaica Limited	382541	0.260	Blenheim	Manchester	262	1536/800

FIRST SCHEDULE, *contd.*PART I, *contd.*

Plan of land part of Blenheim, in the parish of Manchester as set out in table at Part I above.

Applicants Name	Plan Examination Number	Parcel Size (M ²)	Place Name	Parish	Lot	Vol/Folio
JAMALCO for General Alumina Jamaica Limited	382541	0.260	Blenheim	Manchester	263	1536/800
JAMALCO for General Alumina Jamaica Limited	382541	0.146	Blenheim	Manchester	264	1536/800
JAMALCO for General Alumina Jamaica Limited	382541	0.502	Blenheim	Manchester	265	1536/800
JAMALCO for General Alumina Jamaica Limited	382541	0.502	Blenheim	Manchester	266	1536/800
JAMALCO for General Alumina Jamaica Limited	382541	0.502	Blenheim	Manchester	267	1536/800
JAMALCO for General Alumina Jamaica Limited	382541	0.274	Blenheim	Manchester	268	1536/800

FIRST SCHEDULE, *contd.*PART I, *contd.*

Plan of land part of Blenheim, in the parish of Manchester as set out in table at Part I above.

Applicants Name	Plan Examination Number	Parcel Size (M ²)	Place Name	Parish	Lot	Vol/Folio
JAMALCO for General Alumina Jamaica Limited	382541	0.262	Blenheim	Manchester	269	1536/800
JAMALCO for General Alumina Jamaica Limited	382541	0.255	Blenheim	Manchester	270	1536/800
JAMALCO for General Alumina Jamaica Limited	382541	0.644	Blenheim	Manchester	271	1536/800
JAMALCO for General Alumina Jamaica Limited	382541	0.395	Blenheim	Manchester	272	1536/800
JAMALCO for General Alumina Jamaica Limited	382541	0.467	Blenheim	Manchester	273	1536/800
JAMALCO for General Alumina Jamaica Limited	382541	0.262	Blenheim	Manchester	273A	1536/800

FIRST SCHEDULE, *contd.*PART I, *contd.*

Plan of land part of Blenheim, in the parish of Manchester as set out in table at Part I above.

Applicants Name	Plan Examination Number	Parcel Size (M ²)	Place Name	Parish	Lot	Vol/Folio
JAMALCO for General Alumina Jamaica Limited	382541	1.001	Blenheim	Manchester	274	1536/800
JAMALCO for General Alumina Jamaica Limited	382541	0.571	Blenheim	Manchester	279	1536/800
JAMALCO for General Alumina Jamaica Limited	382541	0.491	Blenheim	Manchester	280	1536/800
JAMALCO for General Alumina Jamaica Limited	382541	0.500	Blenheim	Manchester	281	1536/800
JAMALCO for General Alumina Jamaica Limited	382541	0.499	Blenheim	Manchester	282	1536/800
JAMALCO for General Alumina Jamaica Limited	382541	1.013	Blenheim	Manchester	283	1536/800

FIRST SCHEDULE, *contd.*PART I, *contd.*

Plan of land part of Blenheim, in the parish of Manchester as set out in table at Part I above.

Applicants Name	Plan Examination Number	Parcel Size (M ²)	Place Name	Parish	Lot	Vol/Folio
JAMALCO for General Alumina Jamaica Limited	382541	0.517	Blenheim	Manchester	284	1536/800
JAMALCO for General Alumina Jamaica Limited	382541	0.775	Blenheim	Manchester	285	1536/800
JAMALCO for General Alumina Jamaica Limited	382541	0.531	Blenheim	Manchester	286	1536/800
JAMALCO for General Alumina Jamaica Limited	382541	0.493	Blenheim	Manchester	287	1536/800
JAMALCO for General Alumina Jamaica Limited	382541	0.493	Blenheim	Manchester	288	1536/800
JAMALCO for General Alumina Jamaica Limited	382541	0.496	Blenheim	Manchester	289	1536/800

FIRST SCHEDULE, *contd.*PART I, *contd.*

Plan of land part of Blenheim, in the parish of Manchester as set out in table at Part I above.

Applicants Name	Plan Examination Number	Parcel Size (M ²)	Place Name	Parish	Lot	Vol/Folio
JAMALCO for General Alumina Jamaica Limited	382541	0.484	Blenheim	Manchester	290	1536/800

FIRST SCHEDULE, *contd.*

PART II

Plan of land part of Blenheim, in the parish of Manchester as set out in table at Part I above.

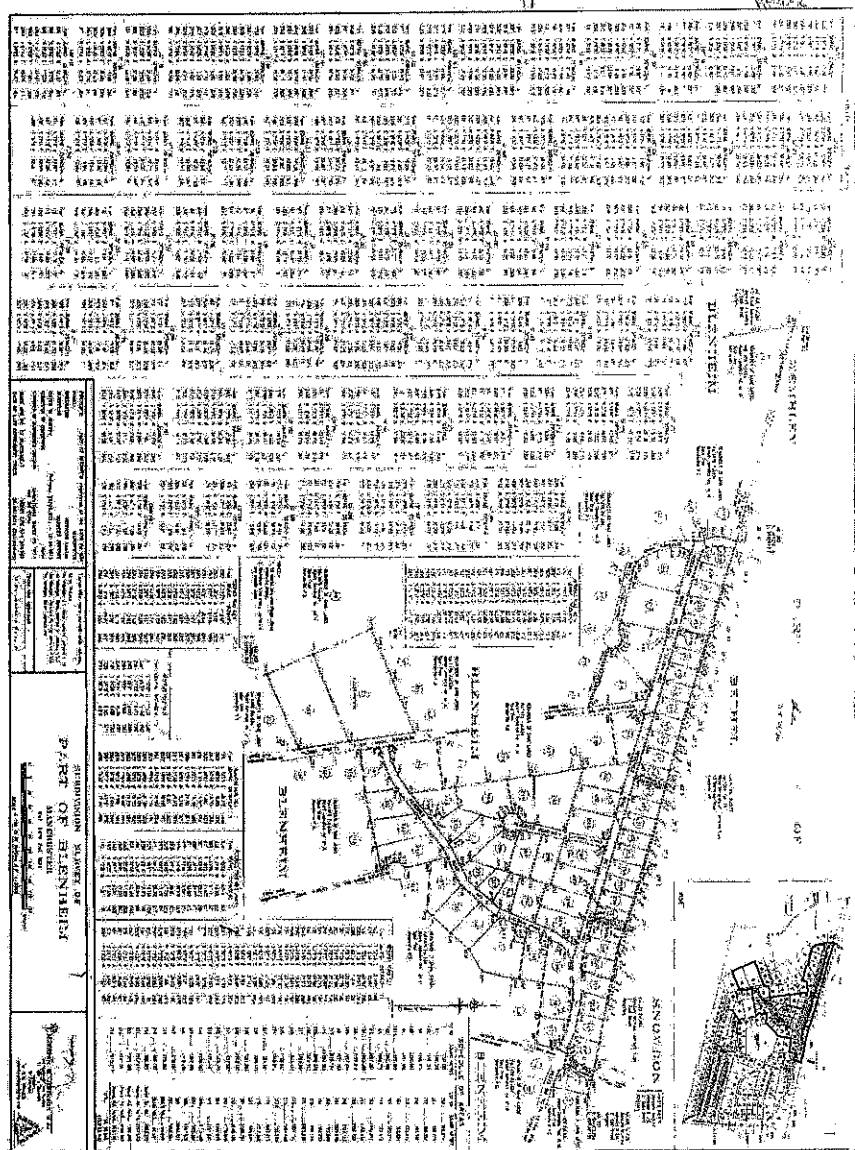
FIRST SCHEDULE, *contd.*PART II, *contd.*

SECOND SCHEDULE

(Paragraph 3)

Covenants

1. There being no breach of existing covenants.

Dated this 21st day of September, 2020.

ANDREW HOLNESS, ON, MP,
Prime Minister and Minister of Economic
Growth and Job Creation.